

h	1.0	1.5	2.0	2.5
r	1 ^{-0.5}	1±0.5	1.5±0.5	2±0.5

端面倒角参照直套

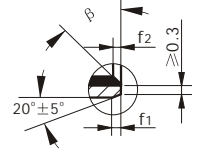
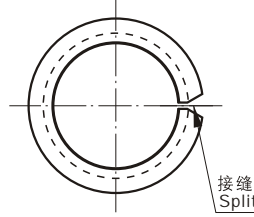

Z 处放大
Magnified

mm

规格型号 Type	轴径 Shaft Dia.	座孔 Housing H7	外径公差 O.D. Tolerance D	压装后 内孔公差 I.D. after fixed d	配合间隙 Clearance	壁厚 Wall Thickness	法兰尺寸 Size Of Washer				
							d	D	F ±0.50	L ±0.25	h -0.2
VS B10F 06040	6 ^{-0.010} -0.022	8 ^{+0.015}	8 ^{+0.055} +0.025	6.055 5.990	0.077 0.000		6	8	12	4	
VS B10F 06070										7	
VS B10F 08055	8 ^{-0.013} -0.028	10 ^{+0.015}	10 ^{+0.055} +0.025	8.055 7.990	0.083 0.003		8	10	15	5.5	
VS B10F 08075										7.5	
VS B10F 10070	10 ^{-0.016} -0.034	12 ^{+0.018}	12 ^{+0.055} +0.025	10.058 9.990	0.086 0.003		10	12	18	7	
VS B10F 10090										9	
VS B10F 10120										12	
VS B10F 12070										7	
VS B10F 12090	12 ^{-0.016} -0.034	14 ^{+0.018}	14 ^{+0.065} +0.030	12.058 11.990		1.005 0.980	12	14	20	9	1
VS B10F 12120										12	
VS B10F 14120	14 ^{-0.016} -0.034	16 ^{+0.018}	16 ^{+0.065} +0.030	14.058 13.990			14	16	22	12	
VS B10F 14170										17	
VS B10F 15090	15 ^{-0.016} -0.034	17 ^{+0.018}	17 ^{+0.065} +0.030	15.058 14.990	0.092 0.006					9	
VS B10F 15120										12	
VS B10F 15170										17	
VS B10F 16120										12	
VS B10F 16170	16 ^{-0.016} -0.034	18 ^{+0.018}	18 ^{+0.065} +0.030	16.058 15.990			16	18	24	17	
VS B10F 18120										12	
VS B10F 18170	18 ^{-0.016} -0.034	20 ^{+0.021}	20 ^{+0.075} +0.035	18.061 17.990	0.095 0.006		18	20	26	17	
VS B10F 18200										20	
VS B10F 20115	20 ^{-0.020} -0.041	23 ^{+0.021}	23 ^{+0.075} +0.035	20.071 19.990						11.5	
VS B10F 20165										16.5	
VS B10F 20215										21.5	
VS B10F 22150										15	
VS B10F 22200	22 ^{-0.020} -0.041	25 ^{+0.021}	25 ^{+0.075} +0.035	22.071 21.990	0.112 0.010	1.505 1.475	22	25	32	20	1.5
VS B10F 25115										11.5	
VS B10F 25165	25 ^{-0.020} -0.041	28 ^{+0.021}	28 ^{+0.075} +0.035	25.071 24.990			25	28	35	16.5	
VS B10F 25215										21.5	
VS B10F 30160	30 ^{-0.025} -0.050	34 ^{+0.025}	34 ^{+0.075} +0.035	30.085 29.990	0.126 0.010		30	34	42	16	
VS B10F 30260										26	
VS B10F 35160	35 ^{-0.025} -0.050	39 ^{+0.025}	39 ^{+0.085} +0.045	35.085 34.990	0.135 0.015	2.005 1.970	35	39	47	16	2
VS B10F 35260										26	
VS B10F 40260	40 ^{-0.025} -0.050	44 ^{+0.025}	44 ^{+0.085} +0.045	40.085 39.990			40	44	53	26	
VS B10F 40400										40	